

**Make sure your CAD drawing includes:**

1. Material type: Apply a material from the materials browser
  2. Material thickness: Right-click the objects and choose Properties. In the Properties palette, select Thickness and enter a new value
  3. Correct dimensions: Click Home tab Annotation panel Dimension Style
  4. Tolerances required: Locate the Tolerances panel and change the upper and lower limit of tolerance from the respective field
- Include forming information if required

**Other best practices:**

- Include individual drawings for each item
- Check for errors, like open contours and duplicate geometry
- 1:1 scale preferred

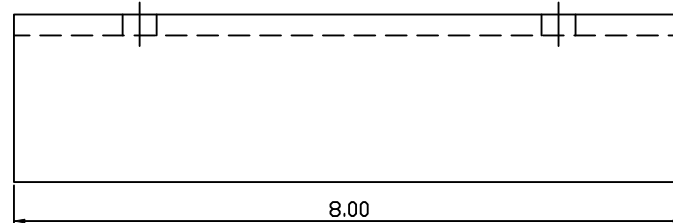
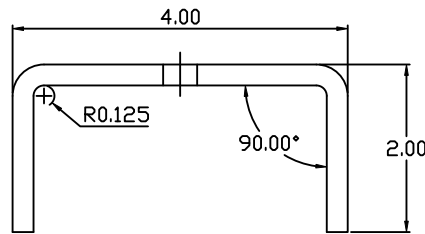
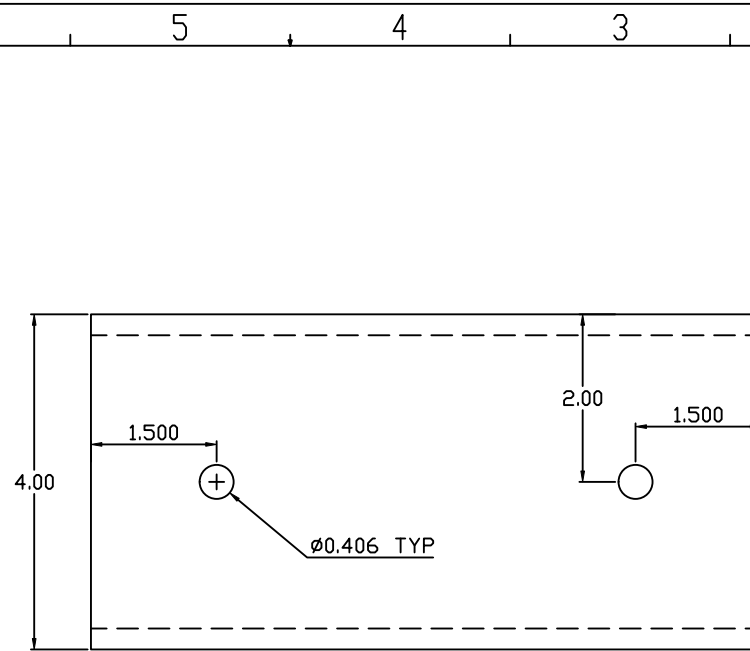

QTY 200

UNLESS OTHERWISE SPECIFIED		NAME	DATE	LASERFAB INC.	
DIMENSIONS ARE IN INCHES		DRAWN		TITLE:	
FRACTIONAL	$\pm .060$	SALES PERSON	JG	12/13/21	CHANNEL
ONE PLACE DECIMAL	$\pm .060$				
TWO PLACE DECIMAL	$\pm .030$				
THREE PLACE DECIMAL	$\pm .005$				
FORMING TOLERANCES:		CUSTOMER NAME			
ANGULAR	$\pm 1^\circ$				
TWO PLACE DECIMAL	$\pm .060$				
THREE PLACE DECIMAL	$\pm .030$				
MATERIAL	HRPD	SIZE A		DWG. NO.	REV
THICKNESS	.25			DET 201	
DO NOT SCALE DRAWING		WEIGHT:		SHEET 1 OF 1	

